

Angle Probe With Replaceable Wedge

There are two Frequency types for selection:

Mid Frequency Bandwidth Series

General purpose, recommended for most applications
Medium Pulse & Medium Damping — perfect combination of gain and resolution
Medium Bandwidth — typical -6dB bandwidth range from 30%~50%

Wide Frequency Bandwidth Series

Gain is usually higher than Mid Freq Series
Wide Bandwidth — typical -6dB bandwidth range from 60%~120%

Ordering Information:

ADP2-1616-70L

Series Code — ADP2
Frequency — 16
Crystal dimension 16×16 — 16
Angle — 70
Connector Type — L

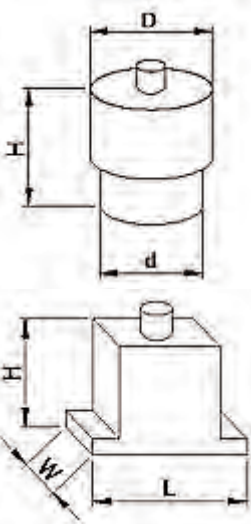

Series Code	Crystal Size (mm)	D	d	H
ADP/LDP/ADM/LDM	Φ3/Φ6	Φ11	Φ9	25
	Φ10	Φ17	Φ14.5	23
	Φ13/Φ14	Φ19	Φ16.8	24

Series Code	Crystal Size (mm)	L	W	H
ADP/LDP/ADM/LDM	13×25	47	19	30
	16×16/16×19	47	25	30
	Φ20	47	25	30

Mid Frequency Bandwidth Series (Transverse Wave ADP and Longitudinal Wave LDP)

Series Code	Frequency (MHz)	Crystal Size (mm)	Angle	Connector Type
ADP LDP	2/2.25/2.5/4/5	13×25, 16×16, 16×19, Φ6, Φ10, Φ13	45,60,70	Blank: BNC/ L: LEMO 00/ L1: LEMO 01/ MD: Microdot
	7.5/10	Φ6		

Wide Frequency Bandwidth Series (Transverse Wave ADM and Longitudinal Wave LDM)

Series Code	Frequency (MHz)	Crystal Size (mm)	Angle	Connector Type
ADM LDM	2/2.25/2.5/4/5	13×25, 16×16, 16×19, Φ6, Φ10, Φ13, Φ14	45,60,70	Blank: BNC/ L: LEMO 00/ MD: Microdot
	7.5/10	Φ3, Φ6		

*Crystal size unit inch is also available: 1/4", 3/8", 1/2".

*Probes with crystal size 6mm are only compatible with LEMO 00 and Microdot.

*Probes with crystal size 3mm are only compatible with Microdot.

Wide Frequency Bandwidth Series

Immersion Probe without focusing

Series Code	Frequency (MHz)	Crystal Size (mm)	Focal Length (mm)	Connector Type
INM	2/2.25/4/5	Φ 6, Φ 10, Φ 13, Φ 14, Φ 19, Φ 20, Φ 24, Φ 25	None	Blank: BNC/ L: LEMO 00/ L1: LEMO 01/ MD: Microdot

Immersion Probe with Line Focusing

Series Code	Frequency (MHz)	Crystal Size (mm)	Focal Length (mm)	Connector Type
ICM	2/2.25/2.5	Φ 6	10	Blank: BNC/ L: LEMO 00/ L1: LEMO 01/ MD: Microdot
		Φ 10, Φ 13, Φ 14, Φ 19, Φ 20, Φ 24, Φ 25	10,20,30	
	4/5	Φ 6	10,20	
		Φ 10, Φ 13, Φ 14, Φ 19, Φ 20, Φ 24, Φ 25	10,20,30	

Immersion Probe with Point Focusing

Series Code	Frequency (MHz)	Crystal Size (mm)	Focal Length (mm)	Connector Type
ISM	2/2.25/2.5	Φ 6	10	Blank: BNC/ L: LEMO 00/ L1: LEMO 01/ MD: Microdot
		Φ 10, Φ 13, Φ 14, Φ 19, Φ 20, Φ 24, Φ 25	10,20,30	
	4/5	Φ 6	10,20	
		Φ 10, Φ 13, Φ 14, Φ 19, Φ 20, Φ 24, Φ 25	10,20,30	

Usage Note: The probe should not be submerged for use over 8 hours. Then keep the probe in dry air for at least 16 hours (in non-operated state) until it is naturally dry before re-use. If the operating time is shortened, the placement period for natural dry can be decreased properly, so as to ensure the normal life of the probe.

Variable-angle Probe



Application:

The reflection angle can be adjusted to meet different requirements.

Ordering Information:

AV2.5-1016L

Series Code

Frequency

Connector Type

Crystal dimension 10×6

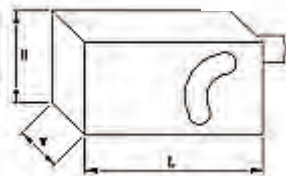

Series Code	Crystal Size (mm)	L	W	H
AV	10×8	60	29	37.5
	10×16	75	33	42

Series Code	Frequency (MHz)	Crystal Size (mm)	Angle	Connector Type
AV	2.5/5	10×8, 10×16	45,60,70	Blank: BNC/ L: LEMO 00/ L1: LEMO 01/ MD: Microdot

Custom Ultrasonic Probe



SIUI can provide custom ultrasonic probes according to specific requirement.

Probe Cable



SIUI provides various of probe cables to be compatible with probes.

There are different kinds of cable connectors for your selection. Such as BNC, LEMO 01, LEMO 00, Microdot, UHF etc.

Probe Test Report



Probe test reports are available as option. (EN 12668-2 compliant)

Storage Boxes



Storage boxes are available.

SIUI

SolCo | World
& Cia | Best
Solutions

SolCo&Cia es Marca Registrada
Representante, servicio técnico y distribuidor General Electric en Chile
www.solco.cl